

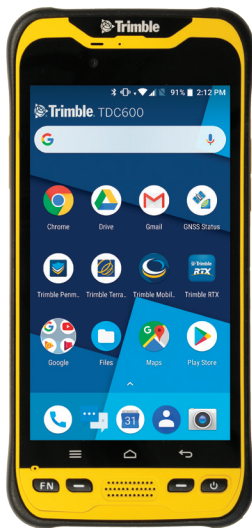

# Trimble TDC600

## HANDHELD



### IN THE BOX

- Trimble TDC600 handheld
- International power adaptor kit / USB cable
- Handstrap kit, lanyard
- Screen protector film

*Note - A screen protector film may already be applied to the handheld.*

**CAUTION** – Read the full user guide including all safety warnings before operating this product.

## INSERT SIM CARD(S) AND MEMORY CARD

1. Remove the battery cover; push the four side locks down to the unlocked position, and push the two top slides down.

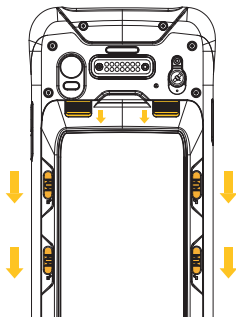

2. Remove the battery; push the battery lock left to the unlocked position, then lift the battery out left-side first.

3. Insert one or two NanoSIM cards as required, metal contacts down. Take note of the direction of the notched corner.

4. If required, insert a MicroSD memory card, metal contacts down, in the slot above the SIM card slots.

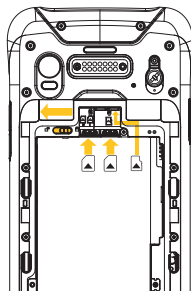

5. Replace the battery and push the battery lock right to the locked position.

6. Replace the battery cover and lock it into place.

## CHARGE THE BATTERY

Fully charge the battery for at least 4 hours before first use. Use the supplied USB cable and AC power adapter, connected to main power.

## ATTACH THE HANDSTRAP

1. Screw the top and bottom handstrap attachments to the back of the handheld.
2. Feed the handstrap ribbon ends through the attachments.
3. Pull one end of the ribbon back towards the center of the handstrap and velcro it to the strap. Repeat with the other ribbon end.
4. Secure the handstrap wrap in place.

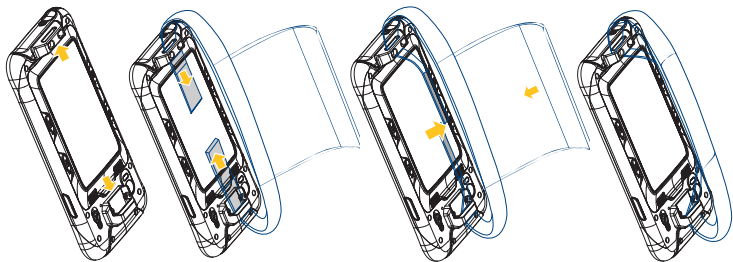

## TURN ON THE HANDHELD

Press and hold the Power key until the device vibrates and emits a sounds. Release the Power key. The Android start screen displays.

Follow the on-screen instructions to configure your handheld.

## BEFORE YOU USE THE CAMERA

Remove the protective film from the rear camera before you take photos.

## TURN OFF THE HANDHELD

Press and hold the Power key until the Power menu appears, then tap Power Off. Briefly pressing the Power key places the device in Sleep state, and it will continue to use battery power.

